



# Interactive Kiosk Floorstand with LED Light and Printer Compartment for Monitors

ADD-IKPS

## INSTALLATION - MANUAL

### CONTENTS:

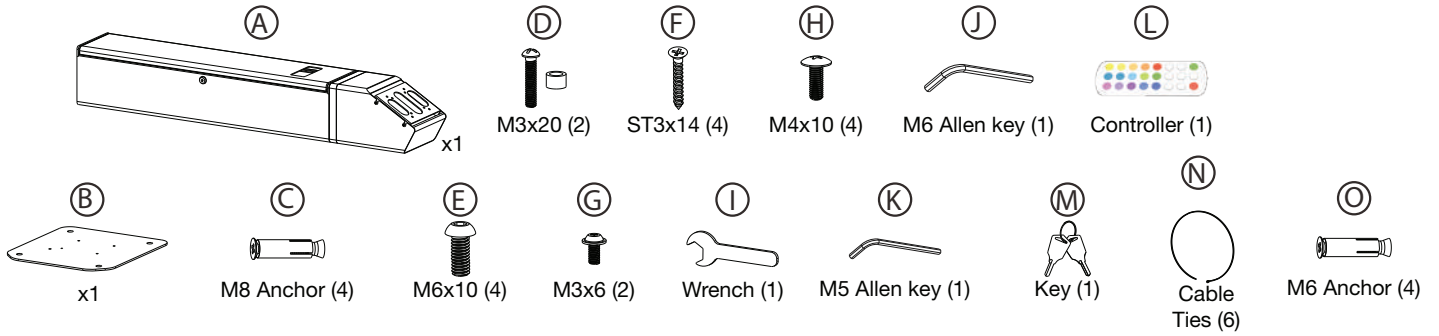

### INSTALLATION:

#### 1- Attaching Base to Body

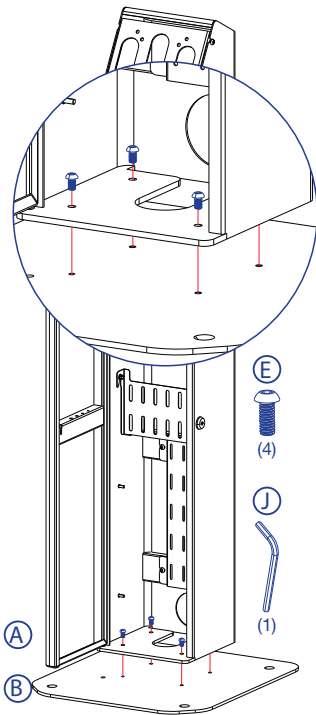

1A. When mounting floor stand body (A) to base plate (B), align the mounting holes as illustrated above. Using four provided allen screws (E), rotate in screws from above using the provided tool (J) until securely tightened.

#### 2- Fixed Mounting

MOUNTING TO FLOOR WITH BASE PLATE  
CABLE ROUTING OUT THE BACK OPENING

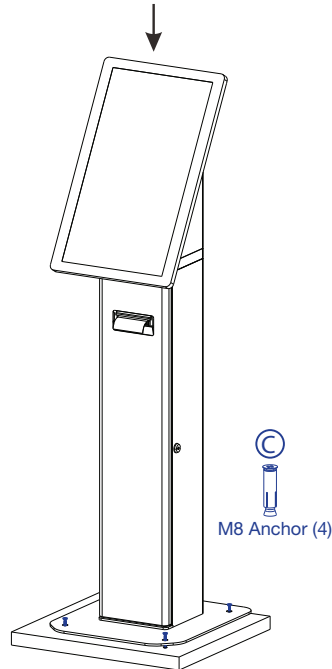

2A. If mounting floor stand and base into ground, first predrill four holes where the mounting holes are. Make sure drill diameter and length match the provided screws (C). Remove floor stand and base. Insert anchors (C). Place the floor stand and base back with holes aligned. Rotate in screws (C) from back above until secure.

MOUNTING TO FLOOR NO BASE PLATE  
CABLE ROUTING THROUGH FLOOR

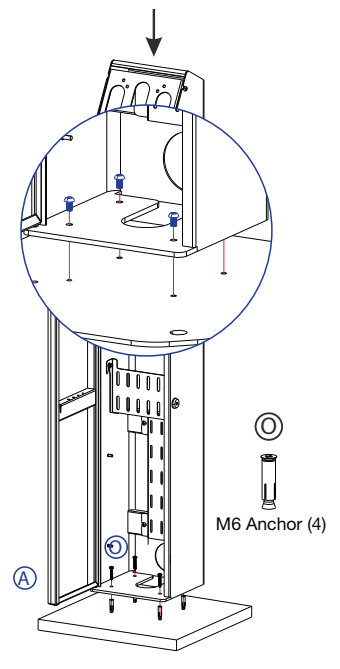

2B. When mounting floor stand body directly into the ground, align the mounting holes to the desired location. Mark off the four locations. Predrill four holes using the same drill diameter and length to match the M6 anchors and screws. Insert four anchors (O) at each hole. Place floorstand back, align holes, and rotate in screws (O) until secure.

### 3- Setting up Mini PC in Dedicated Compartment

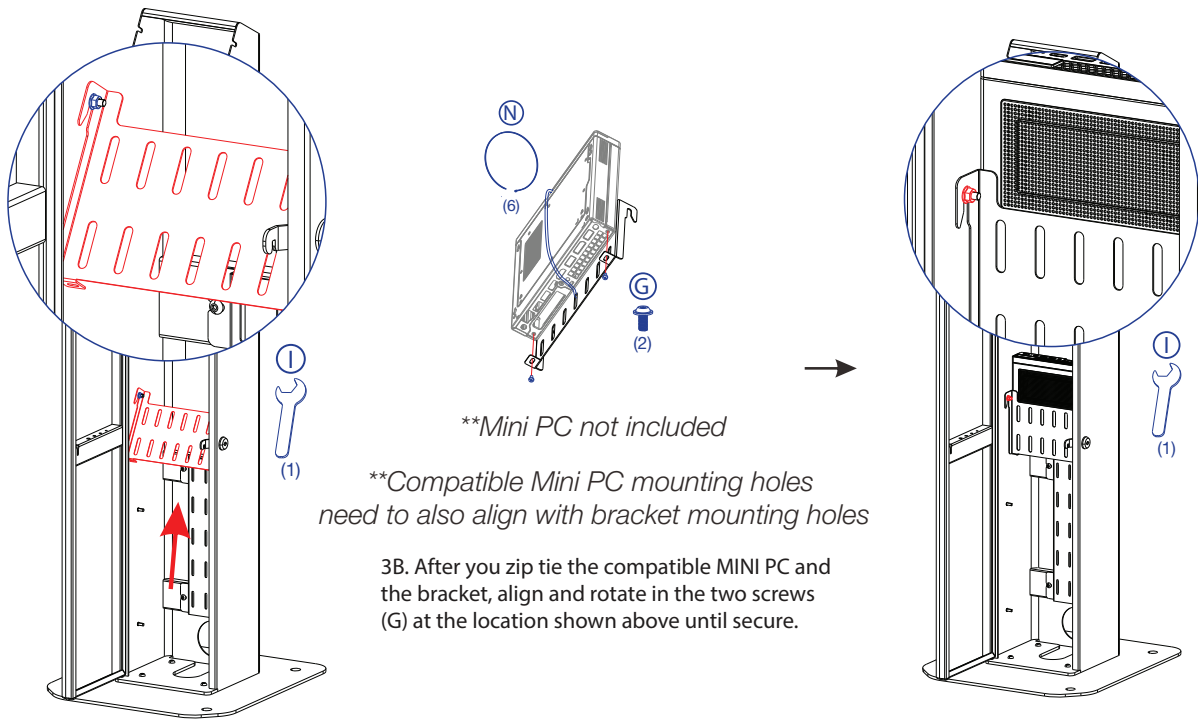

**\*\*Mini PC not included**

**\*\*Compatible Mini PC mounting holes need to also align with bracket mounting holes**

3B. After you zip tie the compatible MINI PC and the bracket, align and rotate in the two screws (G) at the location shown above until secure.

3A. Using provided wrench tool (1), loosen the nuts on each side that the MINI PC bracket is hanging off of. Once loosened enough, you can tilt the MINI PC bracket.

Bring the compatible MINI PC from below, do not remove the bracket. Make sure to align the mounting holes first. Then use a zip tie to hold everything in place first.

3C. With the MINI PC device side facing inwards, angle your MINI PC and bracket combination vertical. Tighten the hexnuts on each side as shown above using provided tool (1) until securely tightened.

### 4- Setting up Power Surge in Dedicated Compartment

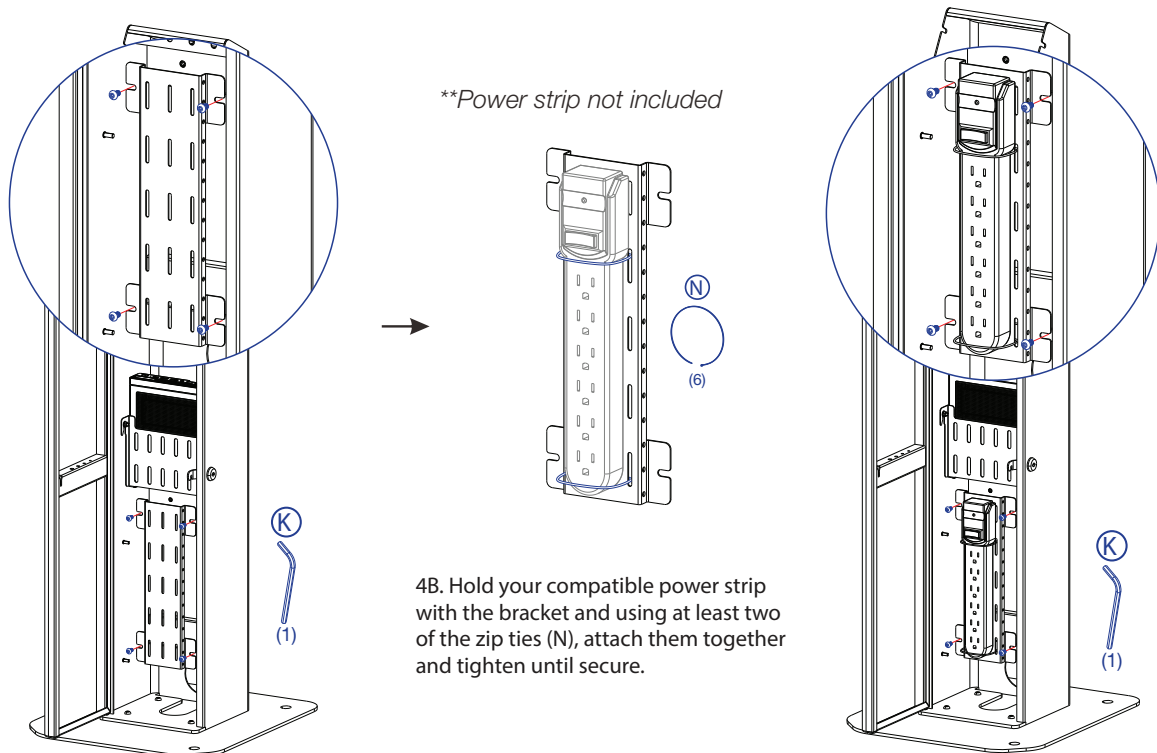

**\*\*Power strip not included**

4B. Hold your compatible power strip with the bracket and using at least two of the zip ties (N), attach them together and tighten until secure.

4A. Find the power surge compartment, and remove the four screws holding up the power surge bracket using provided tool (K).

4C. Take the now attached power strip and bracket and align the mounting holes to that of the floor stands. Rotate in the original four screws using provided tool (K) until

## 5- Attaching Display to Floor Stand

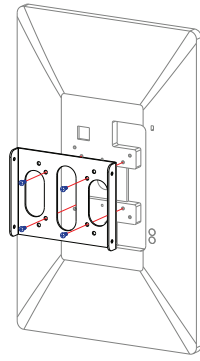
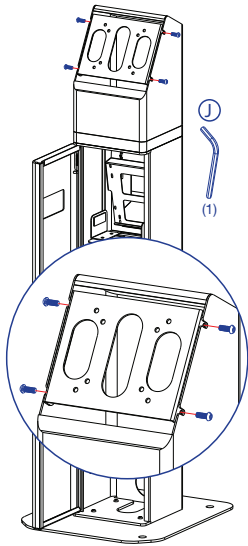

**\*\*Display Screen not included**

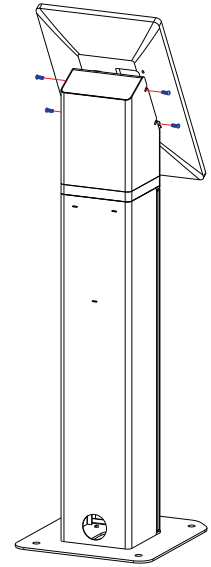
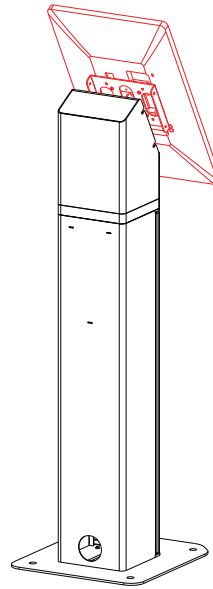

5A. Identify the VESA plate at the top of the floor stand. Remove the four side screws using provided tool (J). Attach VESA plate with compatible display and rotate four screws (H) from behind until securely attached.

5B. Take the now attached VESA bracket and device and align the VESA plate mounting holes back with the floorstand holes. Rotate in four screws using provided tool (J).

## 6- Setting up Printer in Dedicated Compartment

6A. Identify whether you will be mounting a compatible sitting style printer (shown in figure 1) or the wall mounted Epson TM-T88 Series version (figure 2).

**\*\*Printer not included**

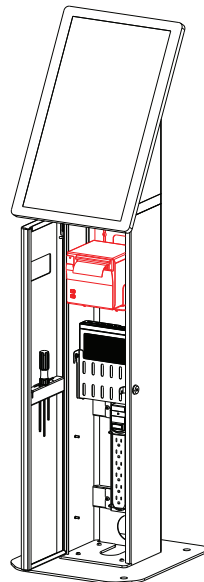

[FIGURE 1]

OR

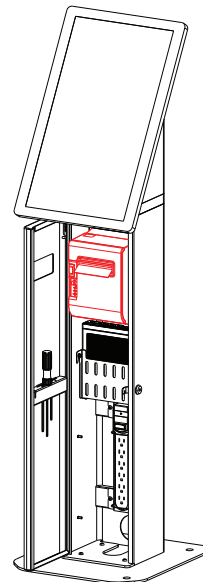

[FIGURE 2]

## 6- Setting up Printer in Dedicated Compartment (continued)

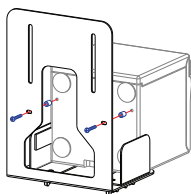

**\*\*Printer not included**

**\*\*Compatible printer mounting holes need to align to L-bracket**

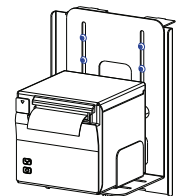
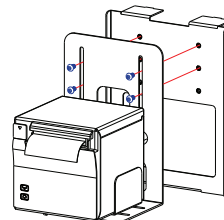
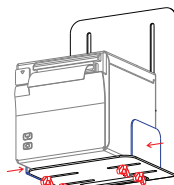

6B. When mounting with a compatible sitting style printer, first align the two mounting holes on the back of the printer to that of the L-bracket. Rotate in screws and hexnut (D) as shown above.

6C. There are clamps on both sides, and slide them up on the vertical edges of the printer. Using the butterfly screws at the bottom, rotate and tighten and set securely.

6D. Take the now attached printer and L-bracket and align the mounting channels to the mounting holes on the main back bracket. Shift the L-bracket + printer up and down to align printer with printer slot on the door. After, rotate in four screws until secure in place.

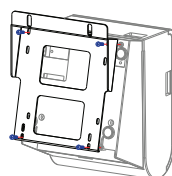

**\*\*Printer not included**

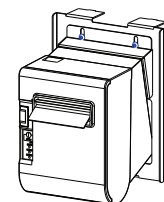
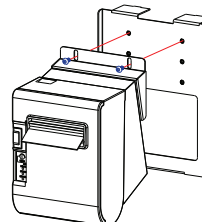
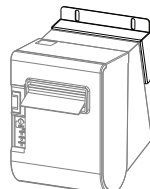

6E. When mounting with Epson TM-T88 series printer, align the back mounting holes to the TM-T88 vertical bracket as shown above. Rotate in four screws (F) from behind until secure.

6F. Take the now attached Epson TM-T88 printer and the TM-T88 vertical bracket and align the mounting holes of the TM-T88 bracket to the mounting holes of the main back bracket. Rotate two screws from the front until secure.

# 7- LED Light Controls

### Music Remote(Advanced Version)

Before using the remote control, pull out the bottom plastic piece

### Controller mode

Light mode switching	10 switching modes
ON/OFF	Turn the light on/off
Music Mode	Press to enter music mode

### APP mode

APP name is " duoCo Strip "

Please search for and install the app in the QR code on the back of the controller .

Download on the **AppStore**

GET IT ON **Google Play**

APP name is "duoCo Strip"

Please search for and install the app in the QR code on the back of the controller .

Functions are listed as follows:

- 1.Manual Light Settings: Adjust the brightness + color temperature of 16 million kinds of colors for monochrome LED strip
- 2.Styles & Modes: Multiple modes to choose from, including stroboscopic, static, gradient, transition...a total of 200+ RGB diversified lighting modes, you can choose the appropriate mode according to the specific scene
- 3.Music Mode: The led lights can change the color and speed of the light according to the rhythm of the music being played
- 4.Microphone Mode: Using the built-in high-sensitivity microphone, when you speak, the light strip will feel the size of your voice inflections and the speed of speaking, and change the color and speed
- 5.Scheduling Settings: Select the date and time to turn on /off the timing light. The lights will turn on/off for the time you set

### HOW TO SHOW THE LAMP LIST AND VIEW LAMP LIST



### SWITCHING TO COLOR AND BRIGHTNESS INTERFACE

### SWITCHING TO MODE SELECTION INTERFACE

### SWITCHING TO MUSIC RHYTHM MODE INTERFACE

### SWITCHING TO MICROPHONE MODE INTERFACE

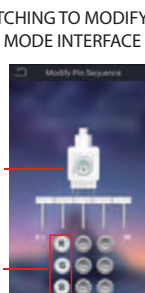
## 7- LED Light Controls (Continued)

<p><b>SWITCHING TO SCHEDULE MODE INTERFACE</b></p>		
<p>Set the time of Light-On</p>		<p>Enable or disable the light-On function</p> <p>Repeat setting No selection for once Light-On</p>
<p>Set the time of Light-Off</p>		<p>Enable or disable the Light-Off function</p> <p>Repeat setting No selection for once Light-Off</p>
<p><b>SWITCHING TO MODIFY PIN MODE INTERFACE</b></p>		
<p>Click to save the new assignment</p>		<p>Change the real color of this line</p>

### Local music:

#### 1. Download local music on android phone:

- (1) Android phone use music players to download songs or copy songs from computers to mobile phones.
- (2) Restart duoCol Strip and switch to music Rhythm Interface to see the newly imported music files.

#### 2. Download local music on iphone:

- (1) Install itunes software on your computer(Apple or Windows)
- (2) Log in to itunes with the same Apple ID account on the Iphone
- (3) Use itunes to import downloaded music files on your computer
- (4) The imported music files will be synchronized to the iphone in real time
- (5) Restart and switch to music Rhythm Interface to see the newly imported music files