



# Premium Locking Security Enclosure for the Zebra ET401 Tablet

PAD-PARAET401

## INSTALLATION - MANUAL

### CONTENTS:

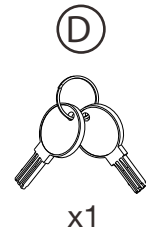
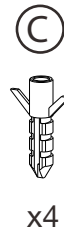
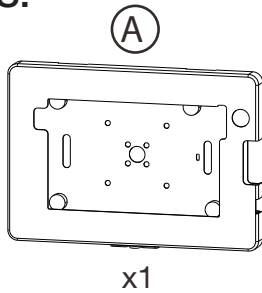

### INSTALLATION:

#### 1- Mounting to Wall

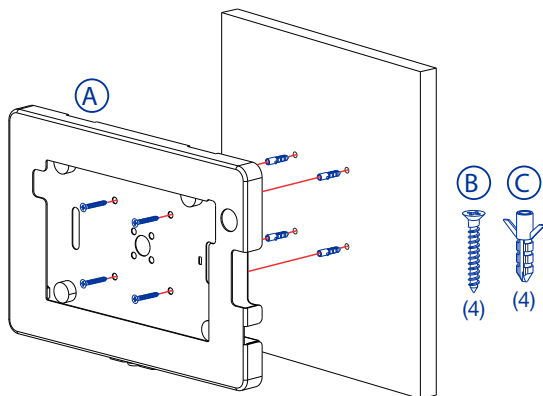

**When Mounting to Wall Using Anchors**

1A - When mounting to wall using anchors, first determine the location. Afterwards, place the enclosure up on the wall and mark off the drill locations using a pencil (not included).

Next, pre-drill the holes using a drill tool (not included) that matches the screw diameter and length. After holes have been drilled, insert the four anchors (C) firmly.

Place the enclosure back against the wall where the holes were drilled. Using a drill or screwdriver tool (not included), rotate in the four screws (B) from the front through the enclosure (A) as shown above. Rotate until securely tightened.

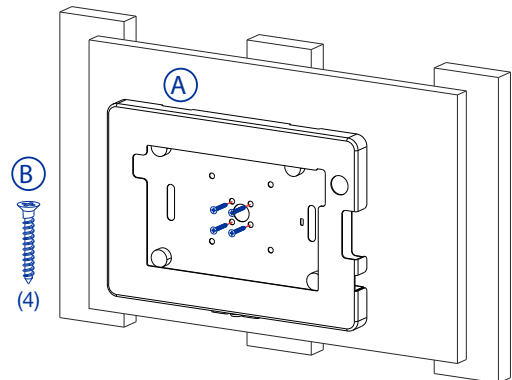

**When Mounting to Wall Not Using Anchors**

1B - When mounting to wall using just screws, place the enclosure on the desired mounting location on wall. Rotate four screws (B) at the the location shown above using a drill tool (not included) until securely tightened.

## 2- Setting Up Device and Cable Routing

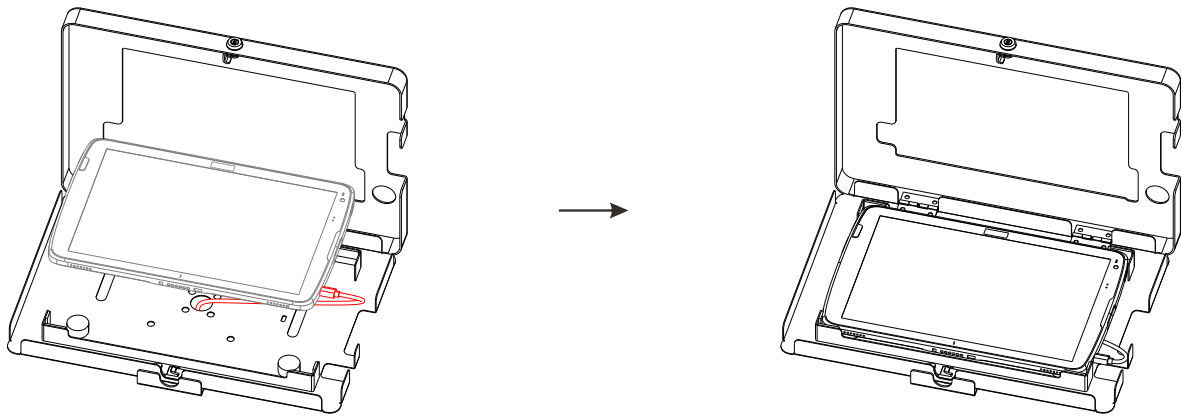

2A - Take the compatible device and make sure the orientation is in the right direction so that all the camera holes and buttons and scanner are in sync with the cutouts of the enclosure.

2B - Place the device down in place gently and securely. When everything is in the right place, close the enclosure.

Next, plug in the power cable as shown and while device is lifted up, fish the wire out the opening in the back as shown above.

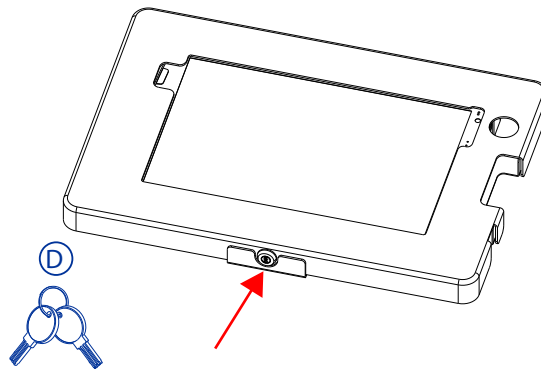

2C - Close the top of the enclosure and using provided keys (D), insert into the key hole and rotate and lock, then remove when secured.

## 3- Attaching to VESA Compatible Base

3A - If attaching to a VESA compatible base, align the 75x75mm VESA holes of the enclosure to the base.

First fish any cords through the body and through the enclosure as shown to the right.

Next, rotate the screws (not included) from the front through the enclosure into the base until securely tightened for all four locations.

