



VersaGuard 1 Unit Pogo Charging Dock

VG-CGD1U

INSTALLATION - MANUAL

CONTENTS:

(A)

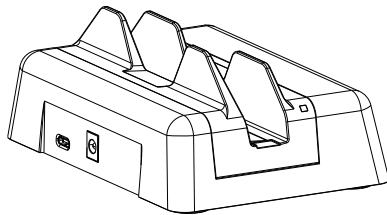

Dock Station x1

(B)

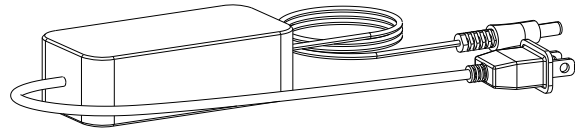

Power Cord x1

INSTALLATION:

1- Attaching Power Cord to Dock

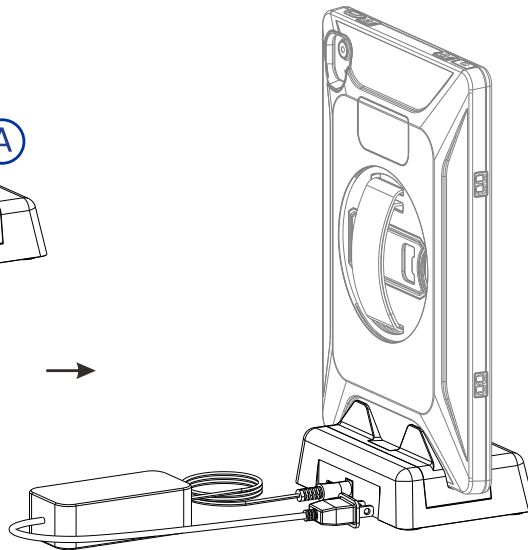
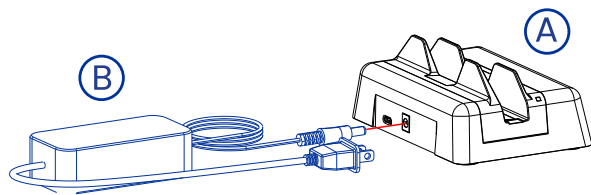

***Case shell not included
**Device is not included*

1A - Plug the power cord (B) into the back of the docking station (A). Then plug the other end of the power cord (B) into an outlet. This powers the dock and gets it ready to charge the device when docked.

2- Red Light Indicator

***Case shell not included
**Device is not included*

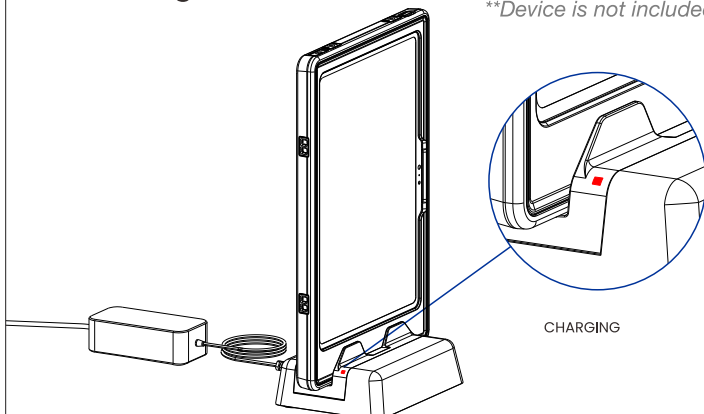

CHARGING

2A - Place your device onto the Dock. A red light will turn on, indicating the device is charging.

3- Blue Light Indicator

***Case shell not included
**Device is not included*

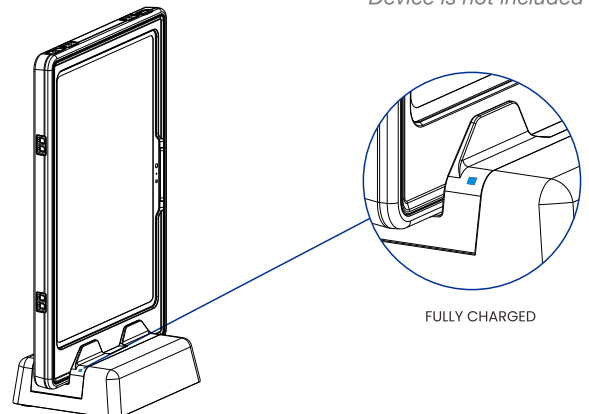

FULLY CHARGED

3A - When the blue light turns on, the device is fully charged and ready to use.