



# Add-On Handle For Rolling Floor Stand (Black/White)

ADD-HANDLEB / ADD-HANDLEW

INSTRUCTION - MANUAL

## CONTENTS:

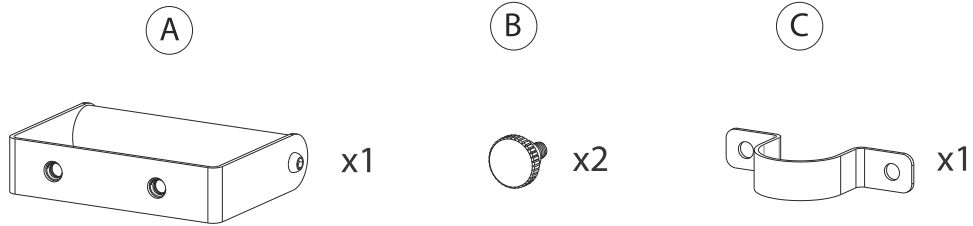

## INSTALLATION:

### 1. SETTING UP HANDLE

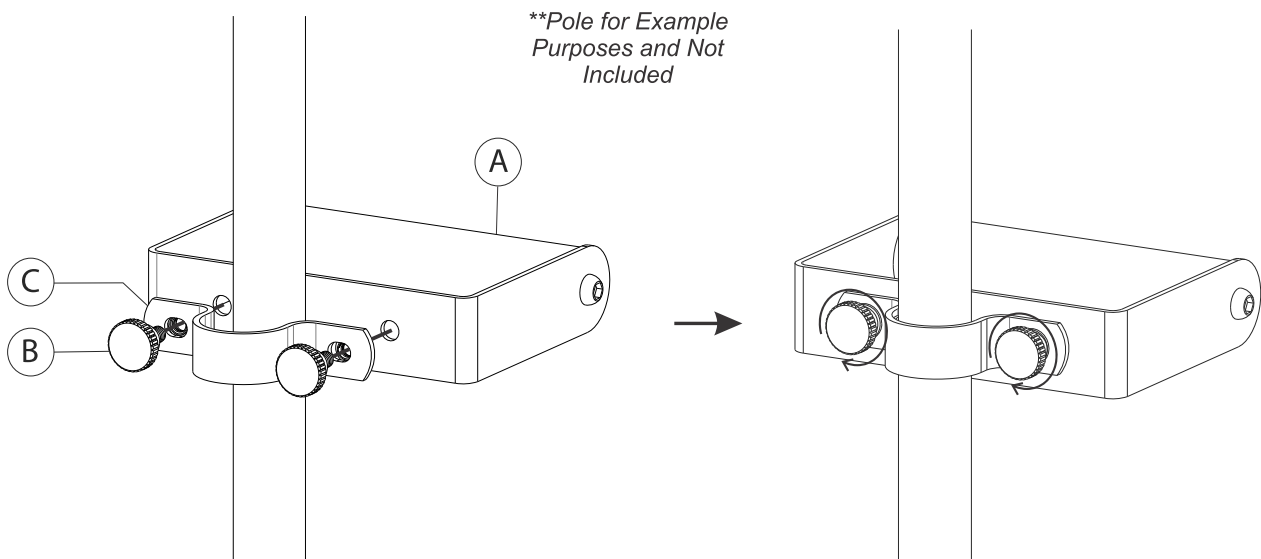

1A. Find the desired height on pole / floor stand where you wish to attach the knob. Then align the knob and clamp (B,C) with the opening in the handle (A).

1B. Rotate in knob clockwise as illustrated above until securely tightened.