



Paragon Premium Locking Floor Stand

PAD-PARAFU

INSTALLATION - MANUAL

CONTENTS:

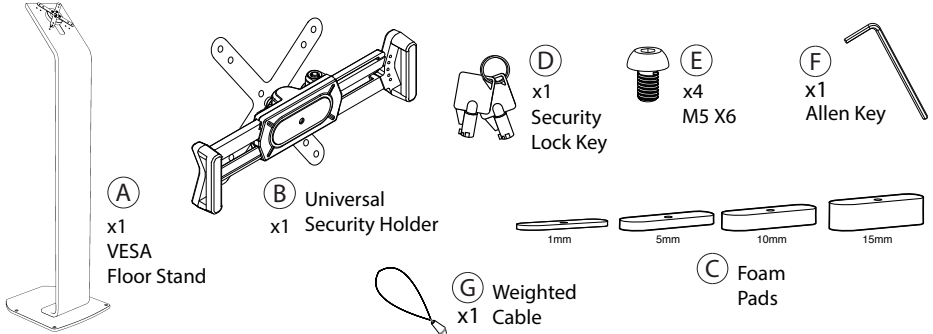

INSTALLATION:

1. Installing Holder to Floorstand

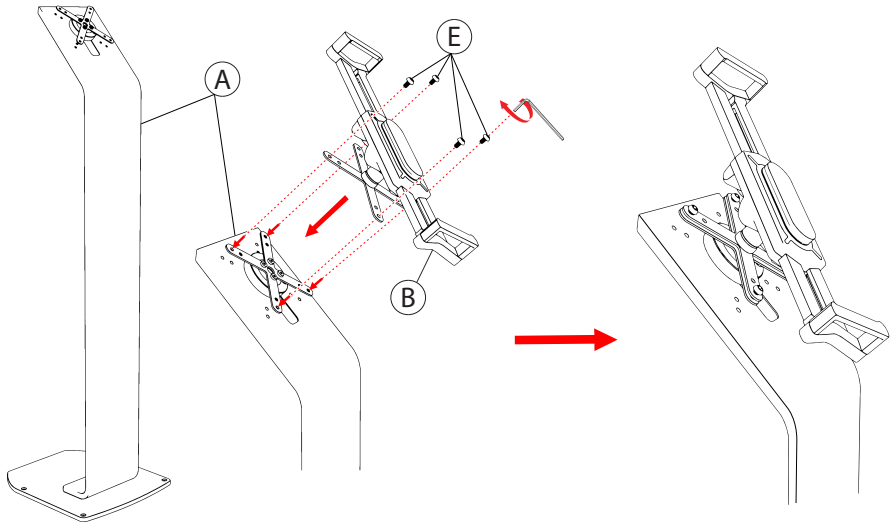

1A. Align VESA plate from universal security holder (B) to VESA plate of floor stand (A). With the provided screws (E) and rotate in with the provided allen key (F) turn it in clockwise through the VESA from universal security holder (B) to the threaded VESA 100mm X 100mm holes until securely tightened.

2. Inserting Tablet to Holder & Attaching Foam Pad

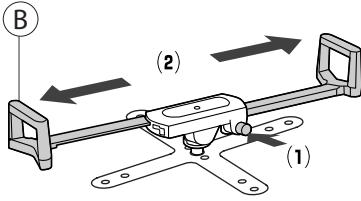

2A. Press and hold the button (1) to release arms then adjust the arms (2) until tablet can fit

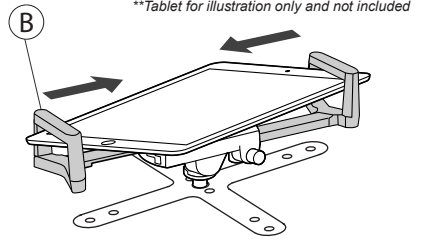

2C. Insert the tablet then retract the arms until the tablet and holder fits securely.

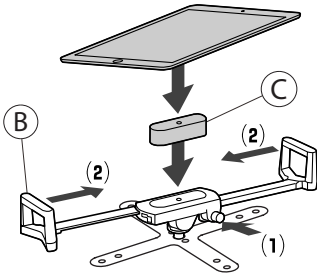

2B. Insert the tablet in Security Universal Holder (B) with the correct foam pad (C). Identify the right foam pad by testing your tablet with various pieces until you find the one that fits securely and snug.

C Adjust the thickness with foam pads

Use the foam to adjust the thickness between the tablet and the holder.

Paste Method

1. Tear off the backing paper on the foam pad.

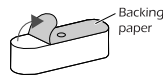

2. Stick the foam pad to the frame as shown.

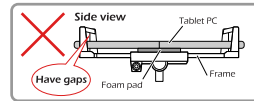
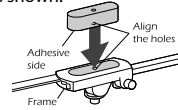

Have gaps

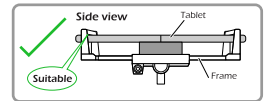

Suitable

3. Securing the Holder

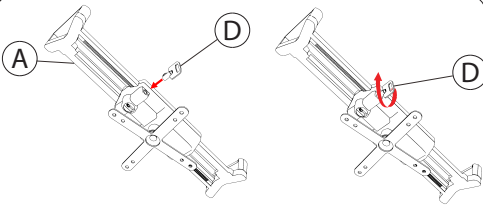

3A. Insert the key (D) to the key opening and rotate clockwise 360 degrees to lock and secure it.

Rotation Adjustability

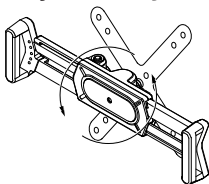

Rotate and adjust to preferred portrait or landscape orientation for preferred setup.

4. Cable Routing through Floor Stand

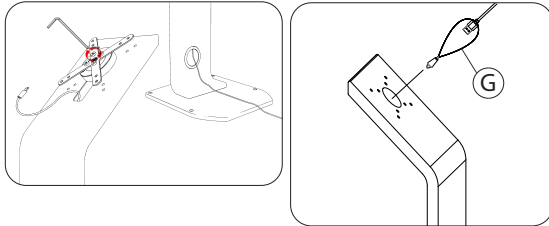

4A. Take the provided allen key tool and rotate clockwise the screws that are attaching the X-VESA joint together as illustrated. Once all screws are out, remove the X-VESA adapter.

4B. Insert cable from top attached to provided fish style weighted cable. Slowly filter cable through the body from top and work your way through to the bottom opening. Remove weighted cable from cable. Connect cable to power source and device and you're ready to go.